

CXH17 Navigation Signal Light



The scope of application

Applied to the ships with the length 50 m or above 50 m as identify signal when night navigation.

Products feature

1. Lampshade and base with threaded connections, it is convenient to replace the bulb.
2. The shell is made of good quality brass foundry.
3. The lampshade adopts poly carbonate material which has the feature of ultraviolet radiation resistance and non-discoloring.
4. Cable outside diameter is $\Phi 11$ mm

Adopt standard

1. Conform to INTERNATIONAL REGULATIONS FOR PREVENTING COLLISIONS AT SEA 1972.
2. Conform to international standard of IEC60598-1-2008.
3. Conform to national standard of GB/T3028-2012.
4. Conform to RULES FOR CLASSIFICATION OF SEA-GOING STEEL SHIPS.
5. Approved by China Classification Society (CCS) and Type Approval of China Fishery Inspection Bureau (ZY).

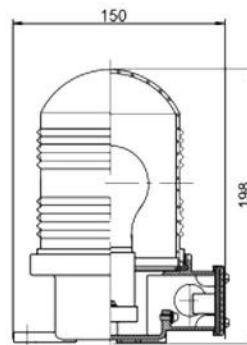
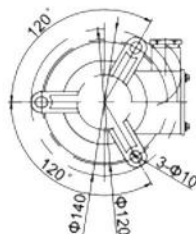

CXH17 Navigation Signal Light Specification

Name	Type	Visibility	Bulb	Color	Weight
Signal Light	CXH17	> 3n.m	220V/65W 110V/65W 24V/60W	Transparent/Red/Green/Yellow/Purple	1.4kg